

**Facades available:**

Callington, Eastwood, Harrogate	
Kent, Lancaster, Sheffield	
Swansea, Wiltshire	
<b>Overall home width</b>	<b>11.99m</b>
<b>Overall home length</b>	<b>23.15m</b>

Residence	190.1m <sup>2</sup>	20.5sq
Garage	36.5m <sup>2</sup>	3.9sq
Porch	6.5m <sup>2</sup>	0.7sq
Alfresco	12.5m <sup>2</sup>	1.4sq
<b>Total</b>	<b>245.5m<sup>2</sup></b>	<b>26.4sq</b>

Listed details based on Sheffield facade floorplan (illustrated)

**FLOORPLAN OPTIONS**

We personalise our floorplans. Talk to us about our huge range of ready-to-go design options or simply visit [www.burbank.com.au/south-australia](http://www.burbank.com.au/south-australia) for more details.

**OPTION K1**

Provide Kitchen upgrade.  
1No. 900mm under bench oven with cooktop and retractable rangehood concealed within 900mm overhead cupboard,  
4No. 800mm base cupboards,  
1No. 1050mm blind carcass with 600mm laminated door.  
1No. dishwasher provision,  
1No. microwave provision,  
1No. 450mm drawer unit,  
1No. 450mm overhead cupboard,  
2No. 800mm overhead cupboards,  
1No. 150mm full height wine rack,  
1No. 900mm open shelf above refrigerator space  
Additional benchtop and tiled splashback to suit  
Provide 2xAFW1206 Aluminium fixed windows with no bottom reveal to Kitchen splashback.

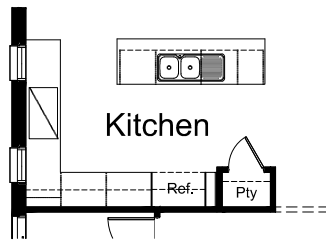

**OPTION K3**

Provide Kitchen upgrade with additional 1200mm deep island bench with 2no. 600mm base cupboards facing Family room,  
1No. 900mm under bench oven with cooktop and retractable rangehood concealed within 900mm overhead cupboard,  
1No. 900mm base cupboards,  
2No. 700mm base cupboards,  
1No. dishwasher provision,  
1No. microwave provision,  
1No. 450mm drawer unit,  
2No. 700mm overhead cupboards,  
Relocate site built plaster lined stud walls with 1no. 620mm door and extend Pantry by 50mm.  
1No. 950mm open shelf above refrigerator space  
Additional benchtop and tiled splashback to suit.

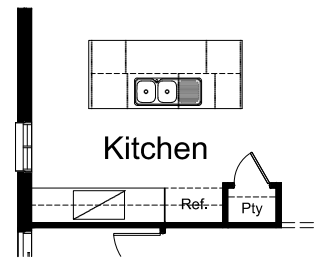

**OPTION K2**

Provide Kitchen redesign by providing U-Shaped Kitchen.  
Relocate site built plaster lined stud walls with 1no. 620mm door and extend Pantry by 50mm.  
1No. 900mm under bench oven with cooktop and retractable rangehood concealed within 900mm overhead cupboard,  
2No. 900mm base cupboards,  
1No. 1050mm blind carcass with 600mm laminated door.  
1No. 900mm blind carcass with 450mm laminated door.  
1No. dishwasher provision,  
1No. microwave provision,  
1No. 450mm drawer unit,  
1No. 400mm base cupboard,  
1No. 400mm overhead cupboard,  
1No. 700mm overhead cupboard,  
1No. 300mm overhead cupboard,  
1No. 950mm open shelf above refrigerator space  
Additional benchtop and tiled splashback to suit  
Provide AFW1218 Aluminium fixed window with no bottom reveal to Kitchen splashback.

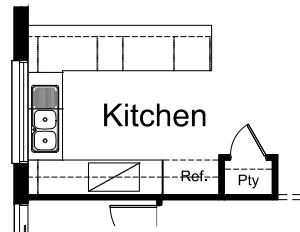

**OPTION ENS2**

Provide Ensuite upgrade with additional bath and tiled hob.  
Provide 720mm Cavity sliding door.  
Relocate shower, vanity unit and toilet to suit.  
Provide ASW1015 Aluminium sliding window.

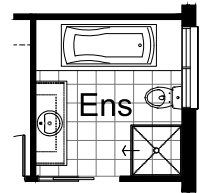

**OPTION ENS3**

Provide Ensuite upgrade.  
Provide 2no. 782 vanity units.  
800mm wide opening with bulkhead over.  
1No. 900mm x 1200mm tiled shower base.  
Relocate toilet to suit,  
Provide ASW1006 Aluminium sliding window.

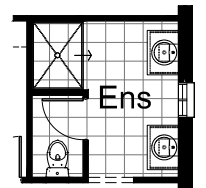

**OPTION ENS4**

Provide Ensuite upgrade.  
Provide 1782 vanity unit with 2no. basins.  
1No. 900mm x 1200mm tiled shower base.  
Provide 1200mm wide opening with bulkhead to Ensuite.  
Relocate opening of WIR to access from ensuite with 1170mm wide opening and bulkhead.  
Provide reconfigured WIR layout with additional 450mm wide shelving to suit.

**OPTION ENS1**

Provide Ensuite upgrade with 900mm x 1200mm tiled shower base.  
Relocate Ensuite window 120 to rear & remove WC/Ensuite wall, door and ASW1006 window to Ensuite WC.

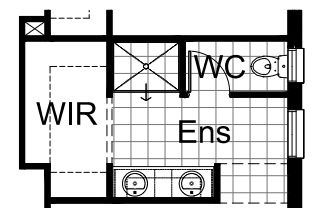
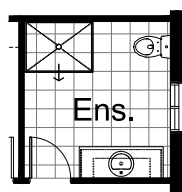

**OPTION LD1**

Provide Laundry upgrade with Laminated insert trough, 1no. 800mm base cupboard, 1no. 450mm base cupboard, 1no. 800mm overhead cupboard, 1no. 450mm overhead cupboard, Additional tiled splash back and bench top to suit.

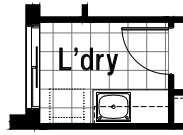

**OPTION G1**

Provide extension to Garage to create additional Storage area. Increases area by 4.58m<sup>2</sup>. Increases width by 850mm.



**OPTION LD2**

Provide Laundry upgrade with Laminated insert trough. Delete standard Broom cupboard and extend Laundry width by 990mm. Provide 2no. 800mm base cupboards, 1no. 400mm base cupboard, 1no. 400mm full height broom cupboard, 1no. 800mm overhead cupboard, 1no. 400mm overhead cupboard, 1no. 800mm open shelf with hanging rail. Additional tiled splash back and bench top to suit.

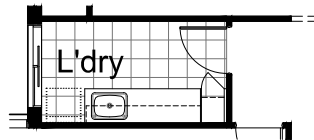

**OPTION G2**

Provide Workshop extension to Garage including 1no. AAWF2015 aluminium feature awning window. Increases length by 2400mm. Increases area by 13.51m<sup>2</sup>.

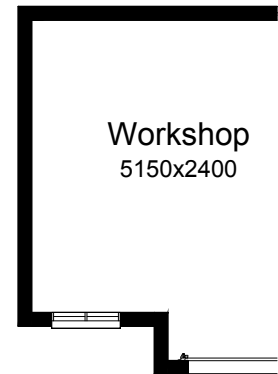

**OPTION IP1**

Provide Real Flame Inspire 900 gas fireplace, 400mm off floor level in a 1400mm x 420mm boxed out plaster wall with a 4 sided black fascia to Family room side wall. Provide 2no. ASW2009 Aluminium sliding windows to Family and 1no. ASW2018 aluminium sliding window to Meals.

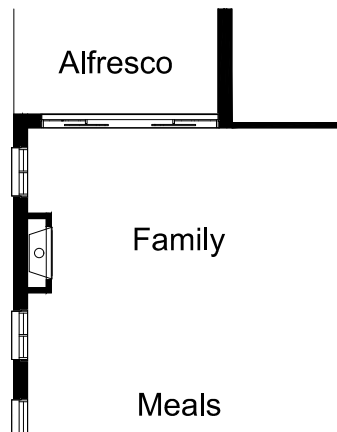

**OPTION IP2**

Provide Gym option in lieu of Bed 4. Provide additional 1no. ASD2127 Aluminium sliding door. Additional 1200mm(h) x 1500mm(w) wall cut out at 1200mm from F.F.L

