

<b>Facades available:</b>	
Coastal, Delta, Kingston, Nouveau	
Salisbury, Traditional, York	
<b>Overall home width</b>	<b>11.15m</b>
<b>Overall home length</b>	<b>23.39m</b>

Residence	182.9m <sup>2</sup>	19.7sq
Garage	37.9m <sup>2</sup>	4.1sq
Porch	2.8m <sup>2</sup>	0.3sq
Alfresco	12.9m <sup>2</sup>	1.4sq
<b>Total</b>	<b>236.7m<sup>2</sup></b>	<b>25.5sq</b>

**FLOORPLAN OPTIONS**

We personalise our floorplans. Talk to us about our huge range of ready-to-go design options.

Listed details based on Traditional facade floorplan (illustrated)

\*Copyright conditions. All photos and illustrations are representative only. Floor plans and specifications may be varied by Burbank without notice, the dimensions are diagrammatic only and a Building Contract with final drawings will display correct dimensions and detail. All designs are the property of Burbank and must not be used, reproduced, copied or varied, wholly or in part without written permission from an authorised Burbank representative. Copyright Burbank Australia (QLD) Pty Ltd. ABN 77 103 014 615. QBCC 1046544.

**Call 13 BURBANK**  
**Visit [burbank.com.au](http://burbank.com.au)**



**OPTION K1**

Provide U-shaped Kitchen upgrade including 900mm canopy rangehood, 900mm electric cooktop, 600mm under bench oven, 450mm drawer unit, dishwasher provision, microwave provision with pot drawer, 1000mm base cupboard, 2No. 900x900mm base corner cupboards, 600mm base cupboard, additional bench top and tiled splashback to suit. Extend plaster and stud wall as shown also.

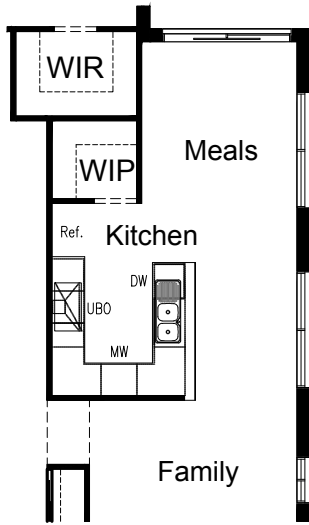

**OPTION LD1**

Provide Laundry upgrade including laminate base cupboards and stainless steel inset trough including 700mm base cupboard, 300mm base cupboard, 700mm overhead cupboard and 300mm overhead cupboard, additional benchtop and tiled splashback to suit.



**OPTION EP1**

Provide floor plan option with mirrored rear section of the house. Walk-in Linen and Linen cupboard are removed. I.T Hub reduces 180mm to 2730mm wide.

