

FLOORPLAN OPTIONS

We personalise our floorplans. Talk to us about our huge range of ready-to-go design options.

Facades available:

Coastal, Delta, Kingston, Nouveau
Salisbury, Traditional, York

Overall home width 12.23m

Overall home length 26.27m

| | | |
|--------------|---------------------------|---------------|
| Residence | 151.4m ² | 16.3sq |
| Unit | 54.3m ² | 5.8sq |
| Garage | 42.0m ² | 4.5sq |
| Porch | 3.6m ² | 0.4sq |
| Alfresco | 13.7m ² | 1.5sq |
| Total | 265.0m² | 28.5sq |

Listed details based on Traditional facade floorplan (illustrated)

*Copyright conditions. All photos and illustrations are representative only. Floor plans and specifications may be varied by Burbank without notice, the dimensions are diagrammatic only and a Building Contract with final drawings will display correct dimensions and detail. All designs are the property of Burbank and must not be used, reproduced, copied or varied, wholly or in part without written permission from an authorised Burbank representative. Copyright Burbank Australia (QLD) Pty Ltd. ABN 77 103 014 615. QBCC 1046544.

Call 13 BURBANK
Visit burbank.com.au

OPTION K1

Provide Kitchen upgrade including 900mm canopy rangehood, 900mm electric cooktop, 600mm under bench oven, 450mm drawer unit, dishwasher provision, microwave provision with pot drawer, 900mm base cupboard, 800mm base cupboard, 700mm base cupboard, 400mm base cupboard, additional bench top and tiled splashback to suit.

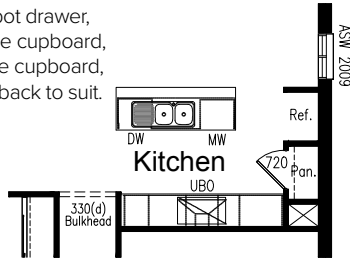

OPTION K2

Provide U-shaped Kitchen upgrade including 900mm canopy rangehood, 900mm electric cooktop, 600mm under bench oven, 450mm drawer unit, dishwasher provision, microwave provision with pot drawer, 2No. 900x900mm base corner cupboards, 900mm base cupboard, 800mm base cupboard, 300mm base cupboard, additional bench top and tiled splashback to suit.

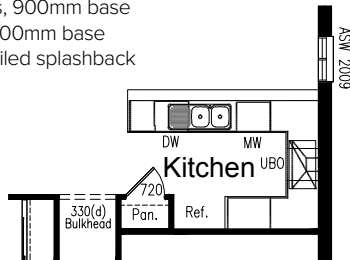

OPTION K3

Provide L-shaped Kitchen upgrade with island bench including 900mm canopy rangehood, 900mm electric cooktop, 600mm under bench oven, 450mm drawer unit, dishwasher provision, microwave provision with pot drawer, 900mm base cupboard, 1No. 900x900mm base corner cupboard, 800mm base cupboard, 600mm base cupboard, additional bench top and tiled splashback to suit.

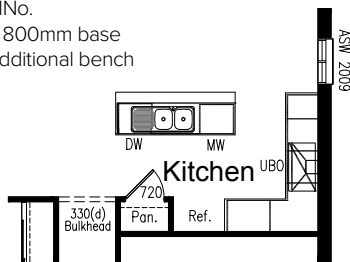

OPTION LD1

Provide Laundry upgrade including laminate base cupboards and stainless steel inset trough including 800mm base cupboard, 450mm base cupboard, 800mm overhead cupboard and 450mm overhead cupboard, additional benchtop and tiled splashback to suit.

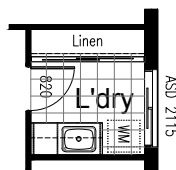

OPTION IP1

Provide Floor Plan option including a mirrored Family and Alfresco area. ASW2021 window to Meals replaced with ASD2121 sliding door for direct access to Private Open Space.

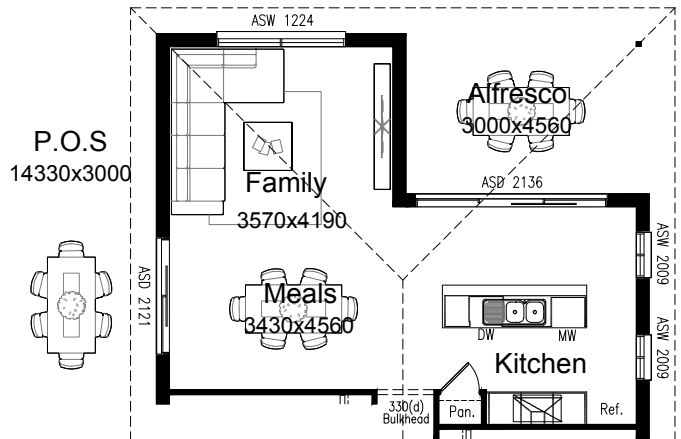

OPTION EP1

Provide Grand Alfresco option including tiled roof, structural concrete slab and 3No. 470x470mm brick piers. Adds 3000mm of length to the building footprint. (Note: only available with a lot length of 35m or greater)

