

# STEPNEY

sheffield façade



lancaster façade



kent façade



wiltshire façade



harrogate façade



callington façade



swansea façade



# STEPNEY 240

4 2 1 2

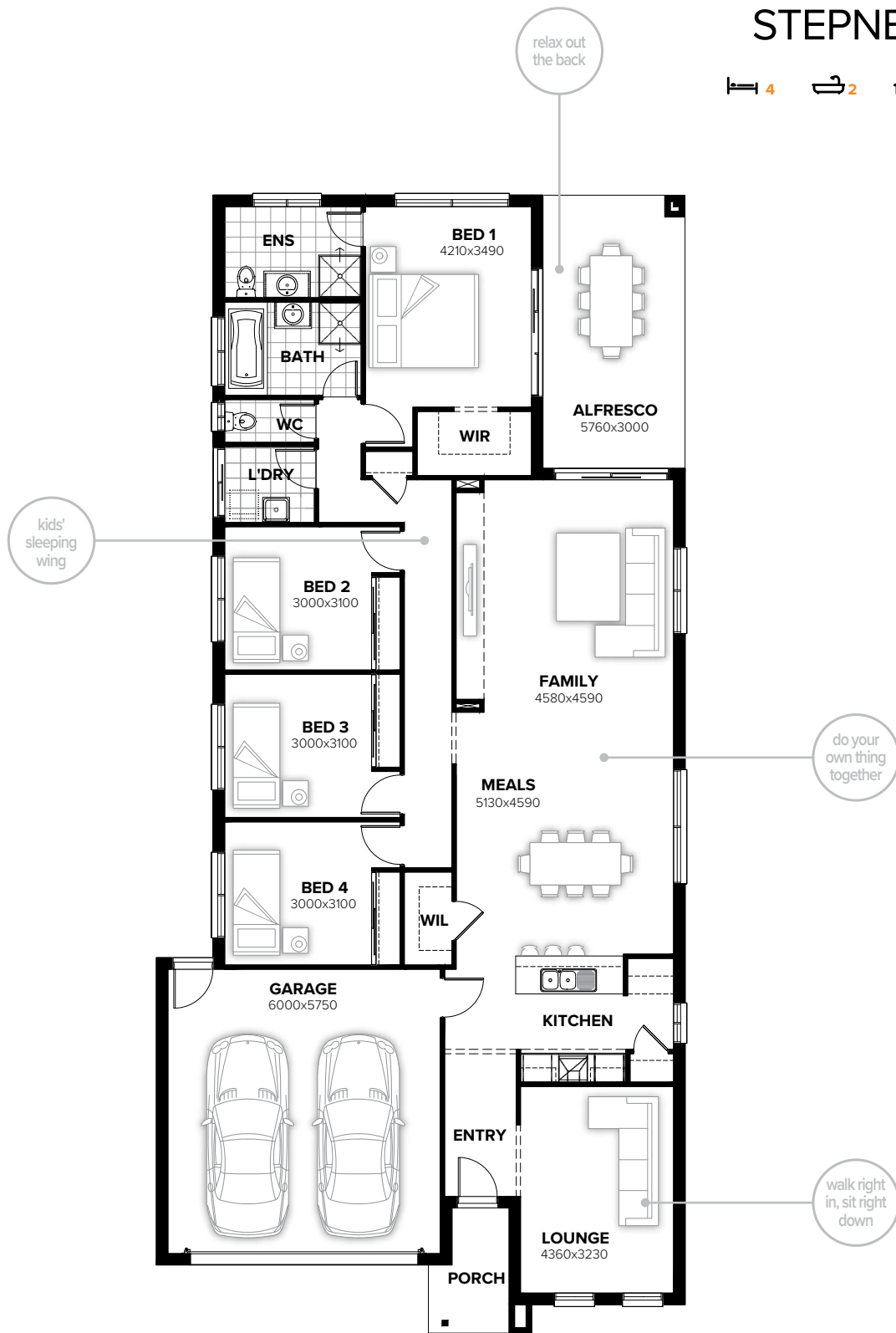

## FLOORPLAN OPTIONS

Want to put a personal touch on your home? Speak to your New Home Consultant about the exciting range of ready-to-go design options for this floorplan.

Popular design options include:

- Kitchen options
- Laundry options
- Ensuite upgrades
- Alfresco option
- Study option to WIL space
- WIR to bed 4 in lieu of WIL

min lot width	12.5m
min lot depth	32.0m
home width	11.15m
home length	23.99m

residence	178.63sqm	19.23sq
alfresco	17.28sqm	1.86sq
porch	3.98sqm	0.43sq
garage	37.89sqm	4.08sq
<b>total</b>	<b>237.78sqm</b>	<b>25.60sq</b>

Listed details based on Sheffield façade floorplan (illustrated)

Call 13 BURBANK Visit [burbank.com.au](http://burbank.com.au)

**Burbank**   
#noplacelikehome

\*Copyright conditions. All photos and illustrations are representative only. Floor plans and specifications may be varied by Burbank without notice, the dimensions are diagrammatic only and a Building Contract with final drawings will display correct dimensions and detail. All designs are the property of Burbank and must not be used, reproduced, copied or varied, wholly or in part without written permission from an authorised Burbank representative. Copyright Burbank Australia (SA) Pty Ltd. ABN 96 165 533 406. BLD 266709.

# FLOORPLAN OPTIONS

# STEPNEY 240



## OPTION K1

Provide Kitchen upgrade including WIP with additional open shelving & separate Refrigerator space with 1no. ASW 1809 window in lieu of standard kitchen layout. Provide extended bench top to kitchen island bench and reconfigure dishwasher space, sink and base cupboards to suit.

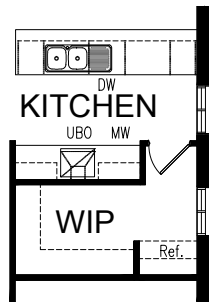

## OPTION K2

Provide Redesigned 'L' shape kitchen layout with Butler's Pantry with additional open shelving and base cupboards with sink, bench top and wall tiles to suit in lieu of standard kitchen layout. Relocate refrigerator space to suit.

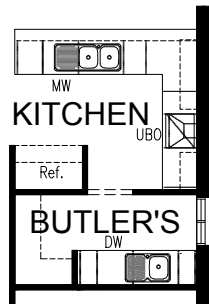

## OPTION K3

Provide WIP with additional open shelving in lieu of standard kitchen layout. Provide WIL to entry hallway in lieu of standard.

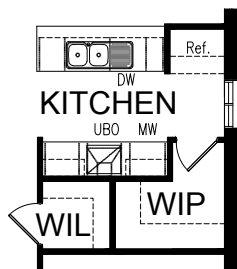

## OPTION LD1

Provide Laundry upgrade by providing laminate base cupboards, sink and bench top in lieu of standard. Additional overhead cupboards also, to suit.

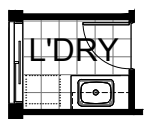

## OPTION ENS1

Provide Ensuite upgrade by providing 1675mm long bath & relocating toilet, tiled shower base and vanity unit to suit. Provide Bathroom redesign by relocating toilet next to shower with 90mm nib wall, tiled shower base and vanity unit to suit. Relocate bed 1 entry door to suit.

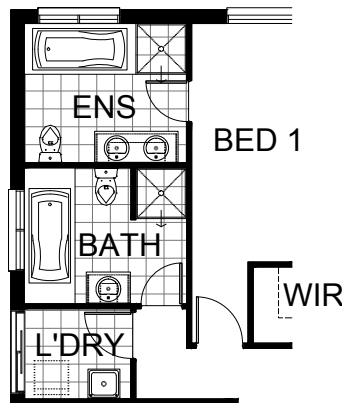

## OPTION ENS2

Provide Ensuite upgrade by relocating vanity unit. Provide enclosed WC with 1no. 720mm hinged door and 1no. ASW 1006 window in lieu of standard.

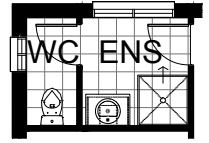

## OPTION ENS3

Provide Ensuite upgrade by extending ensuite by 960mm and relocating toilet and vanity unit. Provide enclosed WC with 1no. 720mm hinged door in lieu of standard. Provide 1675mm long bath and relocate ASW 1215 window to suit.

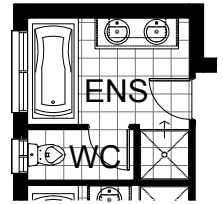

## OPTION IP1

Provide WIR to Bed 4 in lieu of standard robe and WIL.

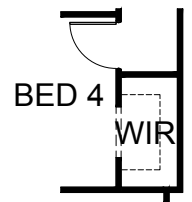

## OPTION IP2

Provide Study option to old WIL space by providing a built in desk in lieu of standard.

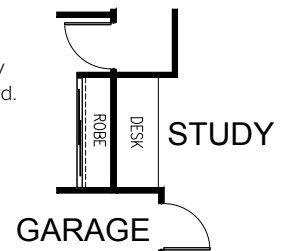

## OPTION IP3

Provide Broom cupboard with 1no. 300mm shelf by reducing and relocating linen cupboard from entry passage to rear passage in lieu of standard.

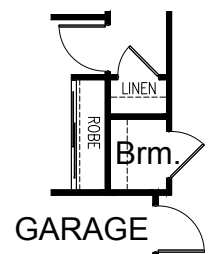

Call 13 BURBANK Visit [burbank.com.au](http://burbank.com.au)

**Burbank**   
#noplacelikehome

\*Copyright conditions. All photos and illustrations are representative only. Floor plans and specifications may be varied by Burbank without notice, the dimensions are diagrammatic only and a Building Contract with final drawings will display correct dimensions and detail. All designs are the property of Burbank and must not be used, reproduced, copied or varied, wholly or in part without written permission from an authorised Burbank representative. Copyright Burbank Australia (SA) Pty Ltd. ABN 96 165 533 406. BLD 266709.

