

GROUND FLOOR

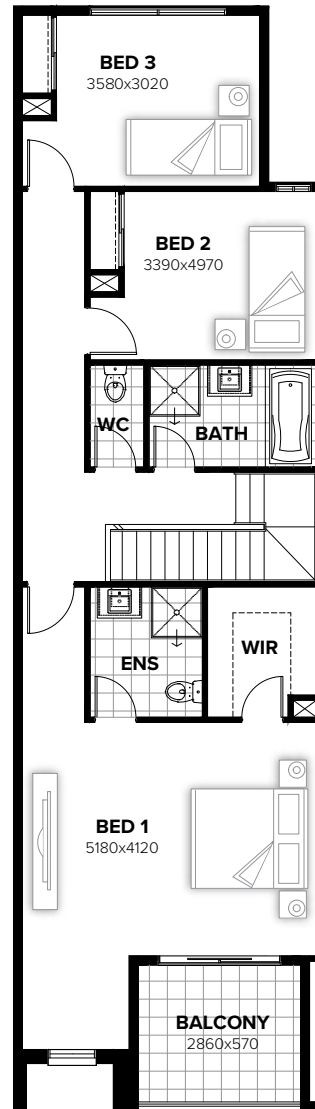

FIRST FLOOR

FLOORPLAN OPTIONS

We personalise our floorplans. Talk to us about our huge range of ready-to-go design options or simply visit www.burbank.com.au/south-australia for more details.

Facades available:	
Urban	
Overall home width	5.50m
Overall home length	19.56m

Residence	163.9m ²	17.6sq
Garage	28.2m ²	3.0sq
Porch	1.8m ²	0.2sq
Balcony	7.4m ²	0.8sq
Total	201.2m²	21.7sq

Listed details based on Urban facade floorplan (illustrated)

*Copyright conditions. All photos and illustrations are representative only. Floor plans and specifications may be varied by Burbank without notice, the dimensions are diagrammatic only and a Building Contract with final drawings will display correct dimensions and detail. All designs are the property of Burbank and must not be used, reproduced, copied or varied, wholly or in part without written permission from an authorised Burbank representative. Copyright Burbank Australia (SA) Pty Ltd. ABN 96 165 533 406. BLD 266709.

Call 13 BURBANK
Visit burbank.com.au

OPTION K1

Provide Kitchen Option with
1No. 600mm base cupboard,
1No 450mm drawer bank,
1No. MW Provision with pot drawer below,
1No. 900mm base corner cupboard,
1No. 800mm Blind base corner cupboard,
1No. 900mm base cupboard,
1No. DW Provision,
32mm Meals table with 2No. fixed legs,
1No. 350mm overhead cabinet,
2No. 800mm overhead cabinets,
1No. 700mm Laminated Pantry unit,
Open shelf above ref. space,
1No. 900mm overhead cabinet,
1No. 900mm cooktop,
1No. retractable rangehood concealed within 900mm overhead cabinet,
1No. 900mm underbench oven,
1No. 900mm Blind corner overhead cabinet.
Additional benchtop and tiled splashback to suit.

